

IMPLANTACION 1:500

CALLE JUEZ DEL VALLE (ASFALTO)
VEREDA

LINEA MUNICIPAL

RETIRO PERIMETRAL (3.00m)

13.61

27.11



CALLE OBEID (ASFALTO)

COSTANERA

23.29

3.13

3.10

- REFERENCIAS**
-  ARBOL
 -  ARBOL A APEAR

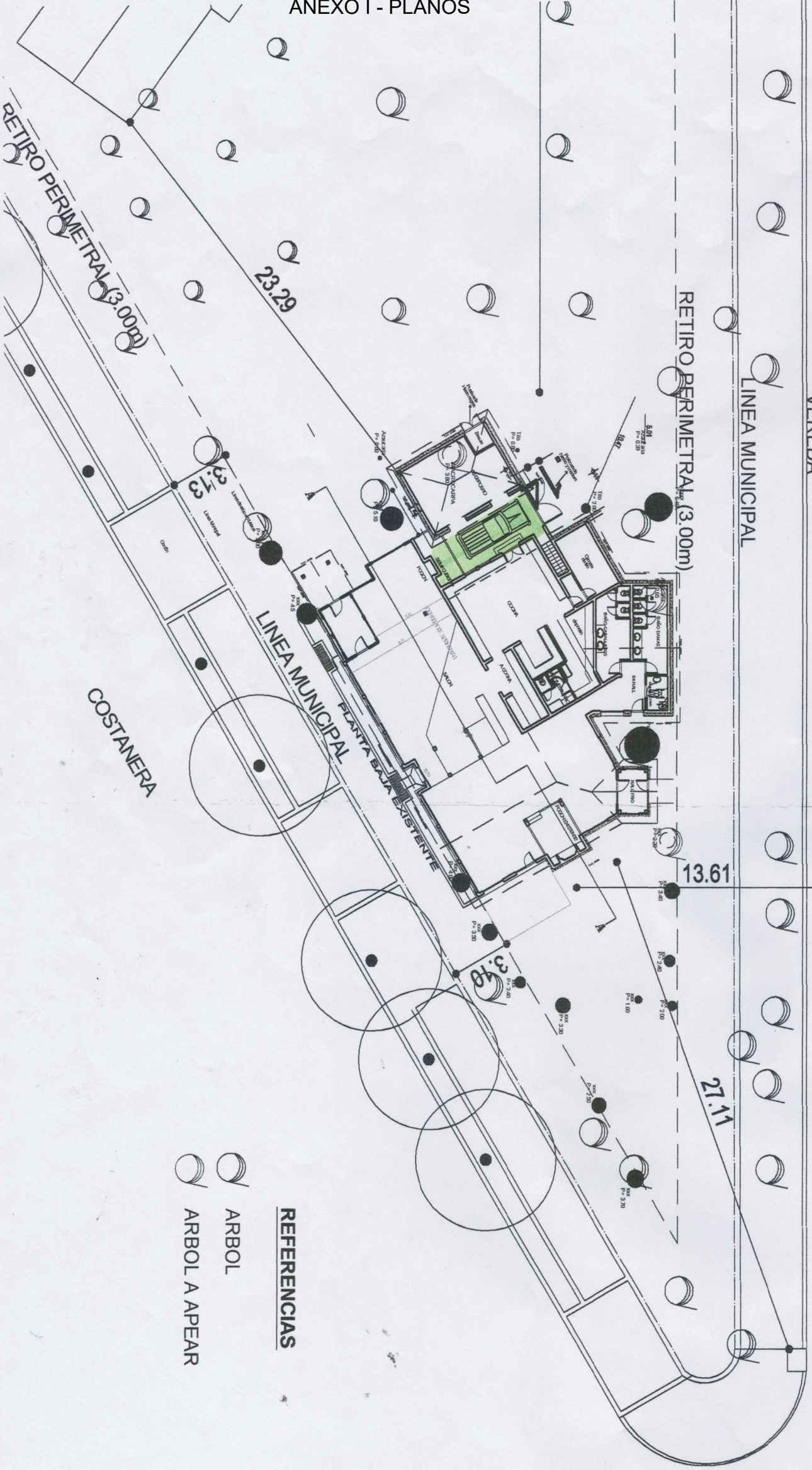

A